

Approved with comments
 Quantity and to be verified by joiner
 Size to be verified on site

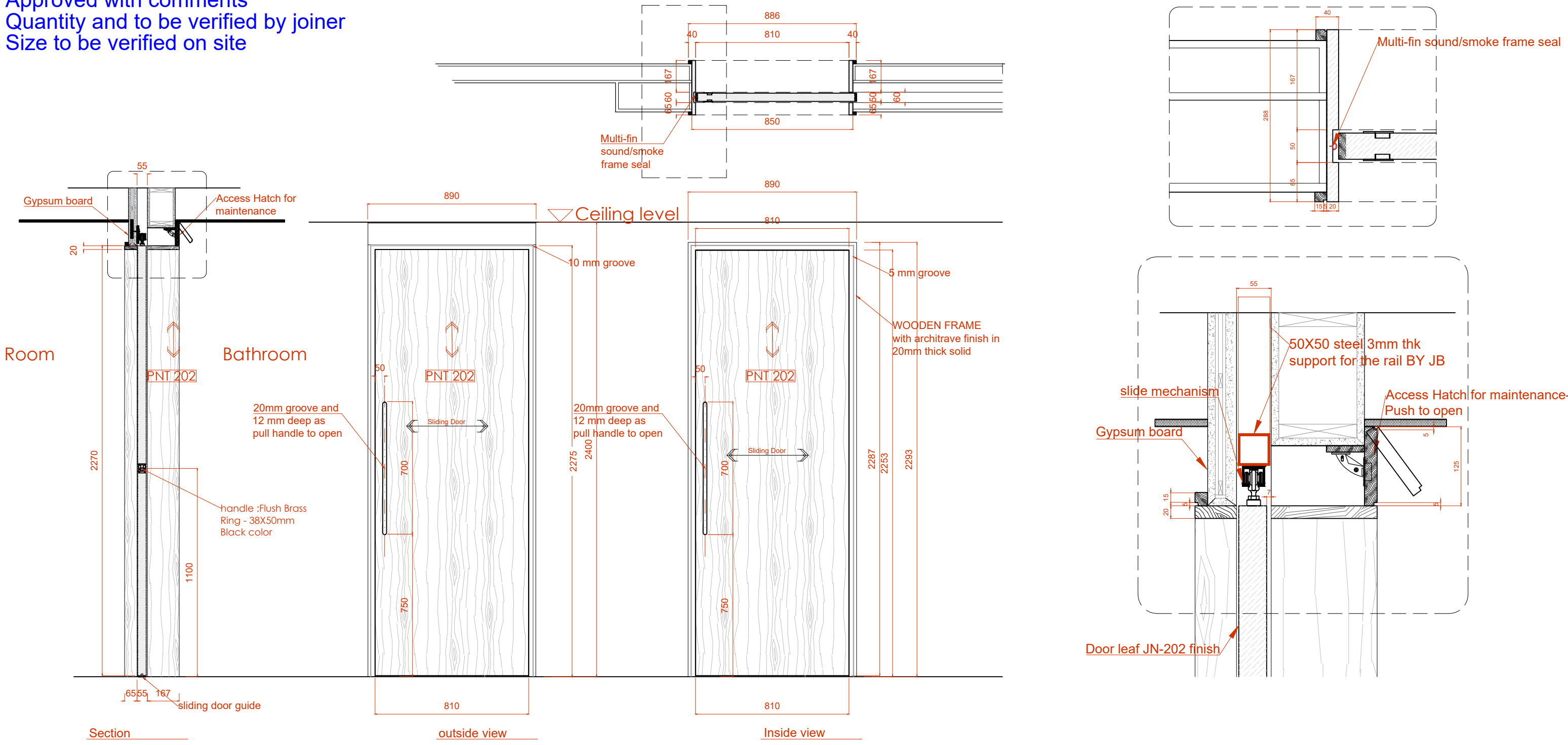

| | | |
|---------------------------|--|--------------|
| D3 | ACC Std rooms Bathroom | |
| panel Size | 810 mm W x 2350mm H x 50 mm thk | |
| Finish | Paninted PNT 202 | |
| Door leaf type | Sliding Pocket door | |
| Ironmongery & Accessories | Handle : Flush Brass Ring | Black Finish |
| | Barn sliding door track : Adjustable upper truck slide mechanism with lower runner for sliding barn door | Black Finish |
| Location | Sliding bathroom door | |
| Total QTY | 126 | |
| Fire Rating | NA | |
| Acoustic | NA | |
| Remarks | | |

